

Using the Deep Map

Point your web browser at:

- <https://deep-map.azurewebsites.net> - Map Digi Penfro
- <https://deep-map.azurewebsites.net/?project=folio> – Sutton Coldfield

It should work on any computer or modern phone.

If not used recently, it may take half a minute to load up.

The screenshot shows the Deep Map interface with several callout boxes explaining its features:

- Mobile? Click > to have the map move with you**: Points to the navigation arrow in the top left.
- Drag the map around**: Points to the map area with arrows indicating movement.
- Switch map type**: Points to the map style selector in the top right.
- Zoom in and out**: Points to the zoom controls in the top right.
- Hover over or tap a place**: Points to a location marker on the map.
- Hover or tap once to see thumbnails. Click or tap again to see it properly.**: Points to a location marker.
- ... or click in the index**: Points to the index list on the left.
- Filter by place tags**: Points to the 'Tags' button at the bottom left.
- Search place descriptions**: Points to the search bar at the bottom left.
- To see the index on a phone, turn it sideways**: Points to the index list on the left.

When you click a place, you'll see some description, and a slide show of any photos that are attached to it.

If you're really excited and want to share the place with someone else, click the link icon at bottom right. Copy the link, and paste it into an email.

If you feel there's something wrong with the material, click "Contact us about this."

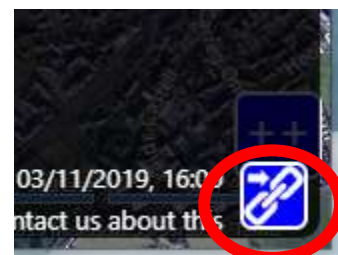

Contributing to the Map

First tell us who you are

If you use a Windows PC, you've registered your email address with Microsoft and have a password for their services. Use that to sign in to the Map.

Or you might have a Gmail or Google password.

If not, it's easy, free, and no hassle to get a Google password. Go to google.com, click Sign In, and then Create Account. They don't pester you with spam or track all your doings (any more than they do anyway).

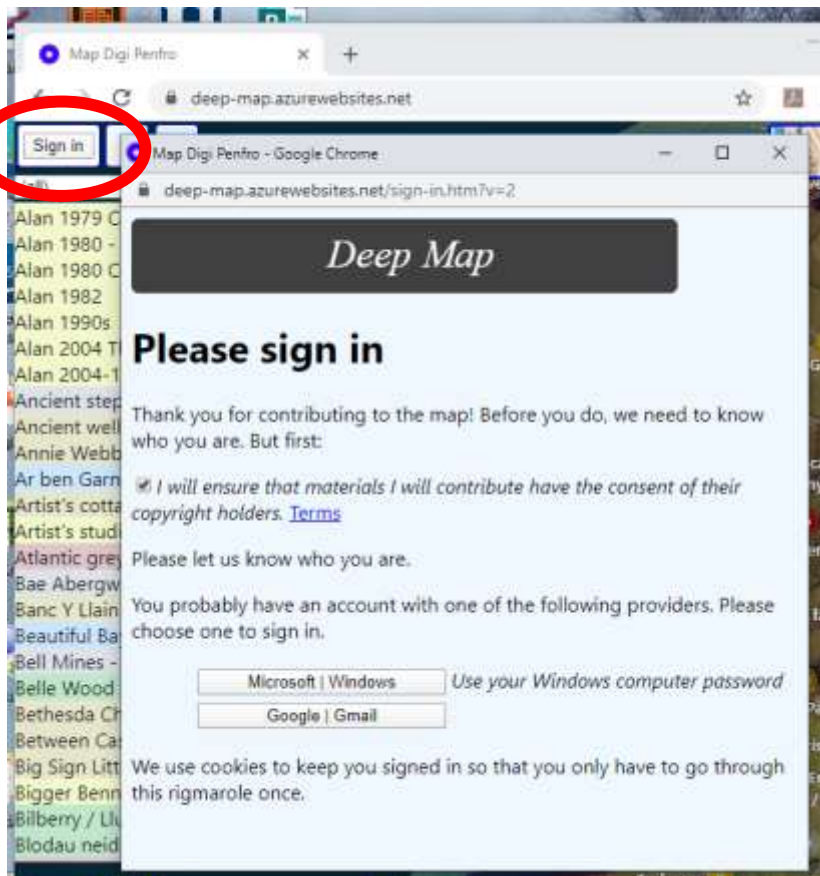

Add a place



Drag the map to position the caret over the place of interest

Click or tap [+]

Edit the title and description, and add pictures

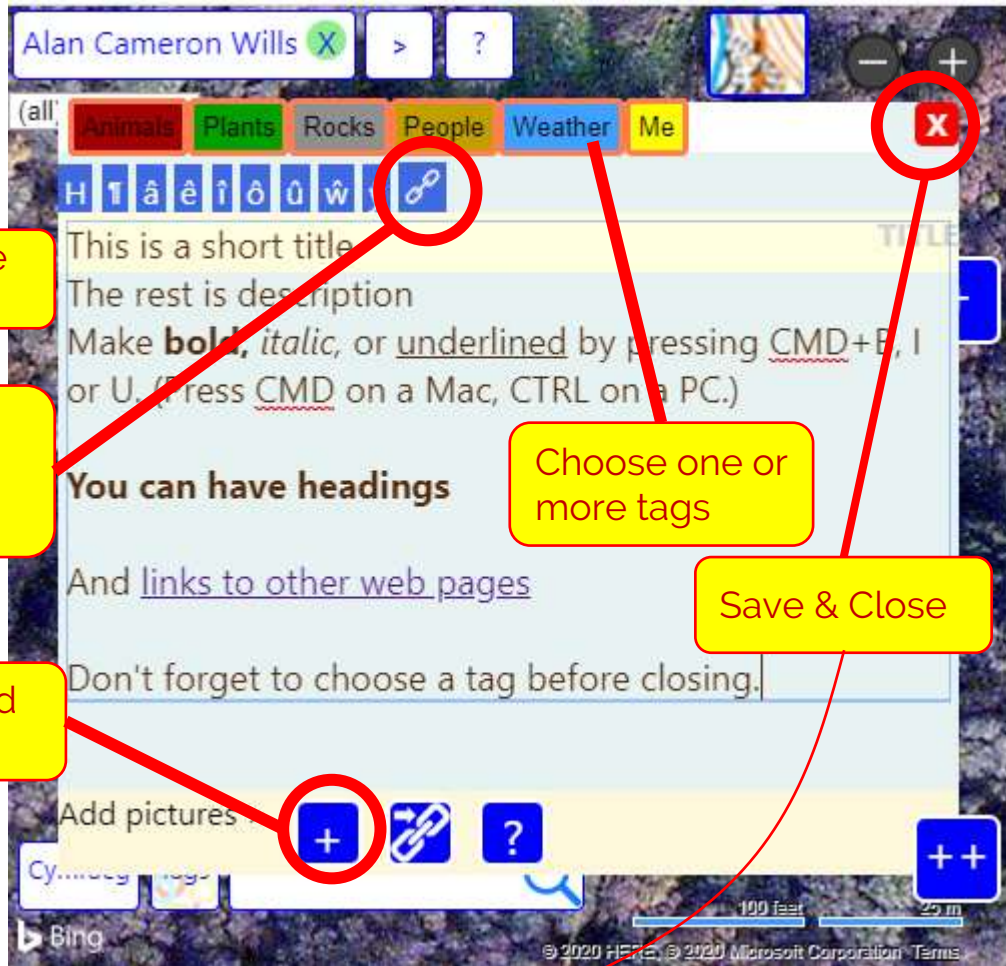

Keep the title (i.e. the first line) short

Link a selected phrase to another web page

Choose one or more tags

Add a picture, sound file, or PDF

Save & Close

Now your place is on the map



Click it to edit it again

Only you and the admins can edit or delete your place. Others can add comments, if they're signed in.

Click it to see it in detail again...

... and to edit it some more, click the pencil at bottom right

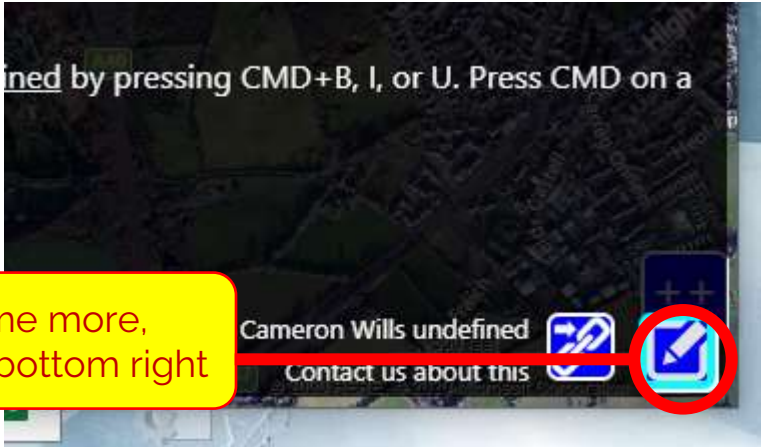

To delete a place

Delete all the text and pictures.

To delete each picture, in the editing form, right-click the picture (CTRL+click on a Mac, long touch on a phone) and choose **Delete pic/file**.

Tediously, you have to delete them one at a time.

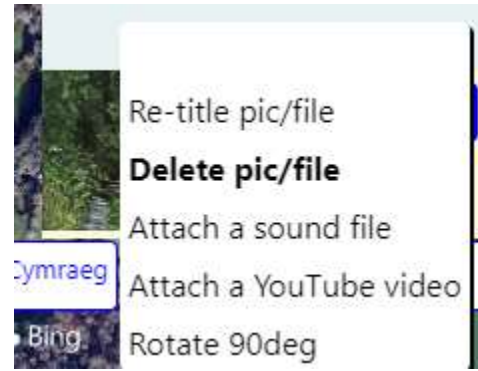

Picture editing refinements

Title each picture – at least with credits

Wrong way up?

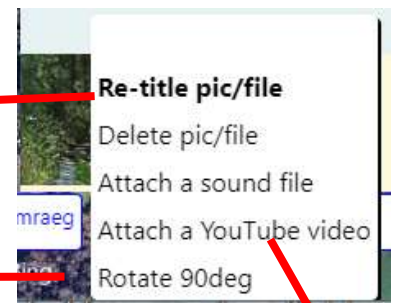

Videos

1. Add a picture to the place
2. Get a Share link from YouTube
3. In the place editor, right-click the picture, choose Attach YouTube, and paste the link

Typically, the picture you add initially is a still from the video.

Sounds

Two ways

Background sound [e.g.](#)

Sound attached to place

- Upload a sound file exactly as you would a photo, along with other photos
- Sound plays when visitors view photos

Narrated slide show [e.g.](#)

Sounds attached to pictures

- Record a talk about the pictures, Snip them into separate files per pic
- In place editor, right-click each pic and **Attach** the relevant sound file
- When visitors view place, each pic plays its talk in turn

Trails

When visitors click one place on a trail, they see all the places on the trail linked up.

If they click a place, they see a slide show that moves through the pictures attached to each place along the trail



1. Enter the places and attach pictures
2. Attach sound files to each picture, if you want to narrate the trail
3. Link the places into a trail:
 - On the map, right-click the first place and choose Start trail
 - Right-click successive places and choose Continue trail

To add to the end of an existing trail, click Start trail

On a Mac, “right-click” = CTRL+click. (Not Opt or Cmd!)

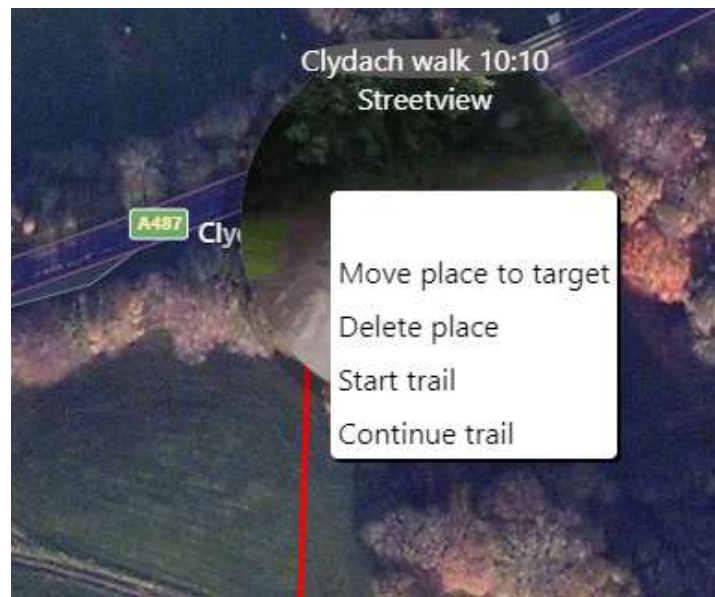

Problems?

Please let me know!

The Deep Map is a project in progress.

Some things might not work quite as you'd like or expect – please let me know if you have any difficulty, so that I can fix it. Sometimes things work OK on one browser but not on another!

You can probably think of some interesting feature you'd like it to have – please tell me about that too!

And do please let me know how you get on with it.

Alan Wills

alan@cameronwills.org